

|                    |                    |
|--------------------|--------------------|
| TEST ITEM          | TEST PRESSURE(PST) |
| SHELL TEST         | 3045               |
| HIGH PRESSURE TEST | 2233               |

## 800LB SWING CHECK VALVE

APPLICABLE STANDARDS  
 BASIC DESIGN: API 602  
 SOCKET-WELDING: ANSI B16.11  
 TEST AND INSPECTION: API598  
 1975PSTIG@100F

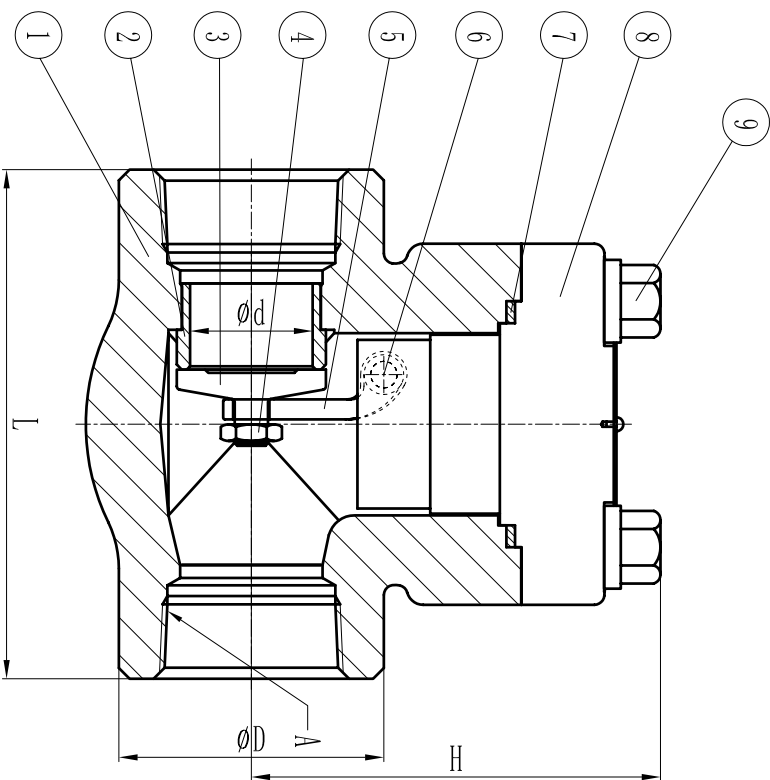

| Size   | L    | H    | d    | D    | A      |
|--------|------|------|------|------|--------|
| 3/8"   | 3.11 | 2.15 | 0.39 | 1.34 | 3/8"   |
| 1/2"   | 3.11 | 2.15 | 0.51 | 1.34 | 1/2"   |
| 3/4"   | 3.62 | 2.15 | 0.51 | 1.58 | 3/4"   |
| 1"     | 4.37 | 2.83 | 0.71 | 1.93 | 1"     |
| 1 1/4" | 4.72 | 3.19 | 0.94 | 2.28 | 1 1/4" |
| 1 1/2" | 4.72 | 3.70 | 1.14 | 2.52 | 1 1/2" |
| 2"     | 5.51 | 4.41 | 1.45 | 3.07 | 2"     |

|     |               |     |                              |
|-----|---------------|-----|------------------------------|
| 9   | BOLT          | 4   | A193-B8M                     |
| 8   | BONNET        | 1   | F316L                        |
| 7   | BONNET GASKET | 1   | SPIRAL WOUNDDED GRAPHITE+316 |
| 6   | PIN           | 1   | A276-316L                    |
| 5   | HINGE         | 1   | CF8M                         |
| 4   | NUT           | 1   | A276-316L                    |
| 3   | DISC          | 1   | A276-316L+STL                |
| 2   | SEAT          | 1   | A276-316L+STL                |
| 1   | BODY          | 1   | F316L                        |
| No. | Part Name     | Qty | Material                     |

JJV Fig# 820-16-THD